

# MOUNTING ACCESSORIES

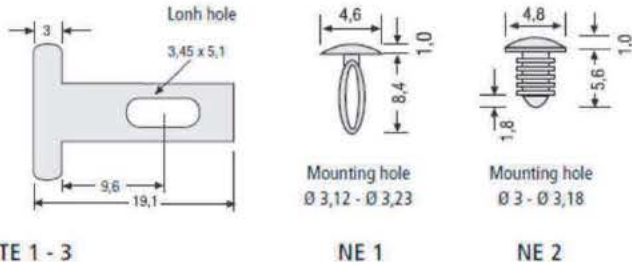

T-end-piece	Part-No.
TE 1 for GK 9	9750
TE 2 for GK 13 - 18	9751
TE 3 for GK 21 - 22	9752
Plastic rivet	
NE 1 for Sheet thickness 0.5 - 1.5 mm	9754
NE 2 for Sheet thickness 0.5 - 1.5 mm	9755

## HALF-ROUND with Tape or Tracks

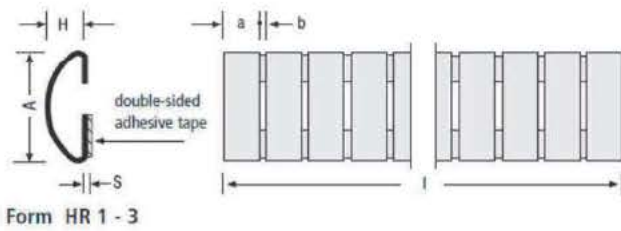

Form	a mm	b mm	A mm	H mm	S mm	l mm	Part-No.
HR 1	4.3	0.5	9.1	2.8	0.08	383	9760*
HR 2	5.8	0.6	11.4	3.6	0.08	383	9761*
HR 3	8.7	0.8	15.8	5.5	0.10	379	9762*

\*Available in CuBe and stainless steel  
Electroplating on request

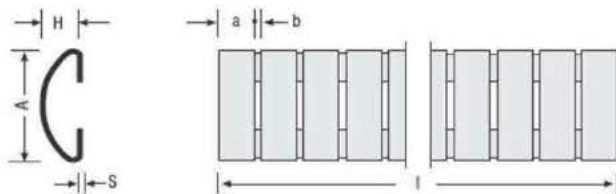

Form	a mm	b mm	A mm	H mm	S mm	l mm	Rivet Number	Part-No.
HR 6	4.3	0.5	9.1	2.8	0.08	383	10	9763*
HR 7	5.8	0.6	11.7	3.6	0.08	383	10	9764*
HR 8	8.7	0.8	15.8	5.5	0.10	379	10	9765*

For mounting tracks  
\*Available in CuBe and stainless steel  
Electroplating on request

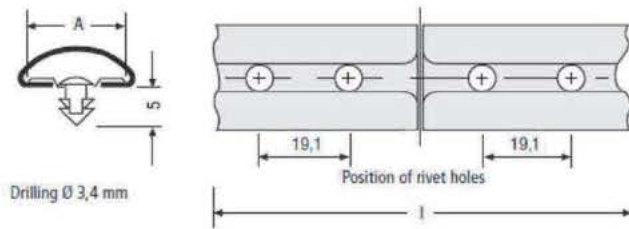

Form	A mm	l mm	Part-No.
MS 6	8.6	383	9766*
MS 7	11.4	383	9767*
MS 8	15.2	381	9768*

Material: brass, bright finish

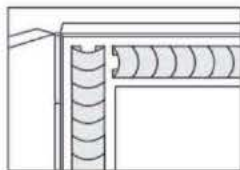

HR 1 - HR 3

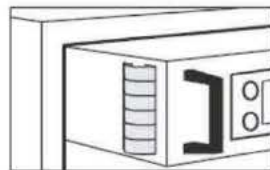

HR 6 - HR 8

### Mounting examples